



## Basildon Court

Devonshire Street, Marylebone, W1G 6PP

**£495 Per Week**

A spacious and fantastically located studio is situated on the third floor (WITH LIFTS) of a prime portered residential building located just off Marylebone High Street.

The flat comprises of:- Studio room with sitting area : sofa and desk with chair, separate kitchen, shower/WC and there is also a good sized double bed, large window and wooden flooring.

Basildon Court is located on the corner of Marylebone High Street and Devonshire Street with plenty of cafés, bars, restaurants, boutiques and large Waitrose right at the doorstep, with Oxford Street, Baker Street and Regent's Park being only a short stroll away. The building also benefit's from having a day porter and smart lobby, affording with COMMUNAL heating and HOT water included in rental.

The property is offered furnished and is available from NOW! for long let (with break option).

- Studio Flat
- Shower/WC
- Separate Kitchen
- Wood Flooring
- Third Floor
- Lifts
- Day Porter
- Communal heating/HW
- Mavellous Marylebone Location

### Viewing

Please contact our Messila Residential Office on 020 7586 6699 if you wish to arrange a viewing appointment for this property or require further information.



0



1



1



D

Floor Plan

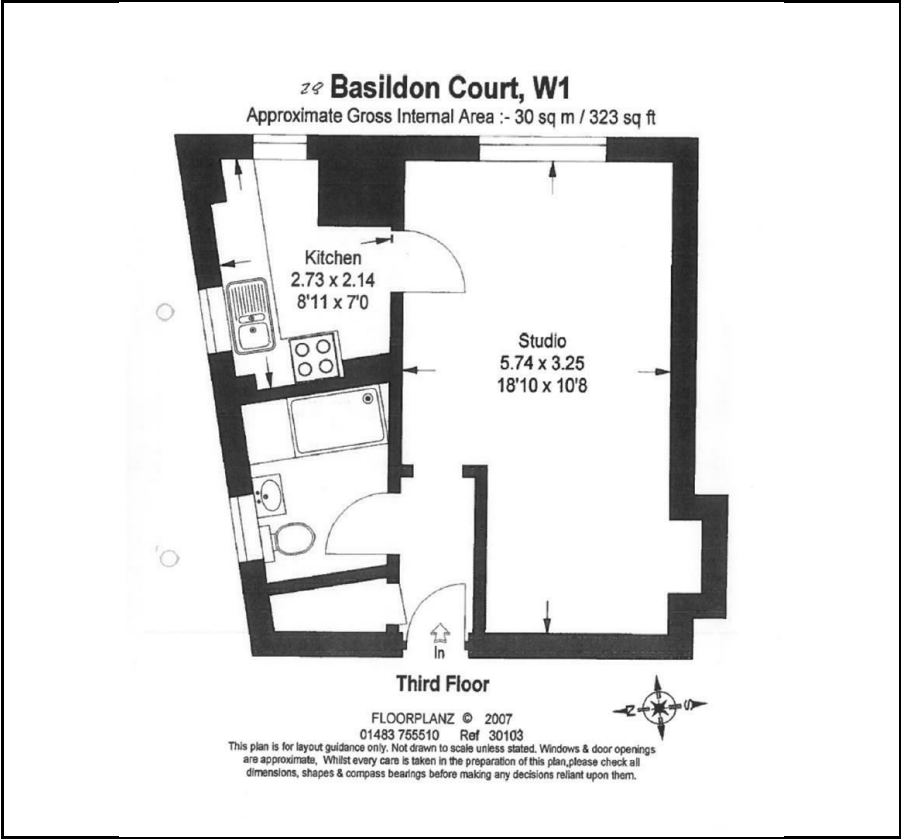

Area Map



Energy Efficiency Graph

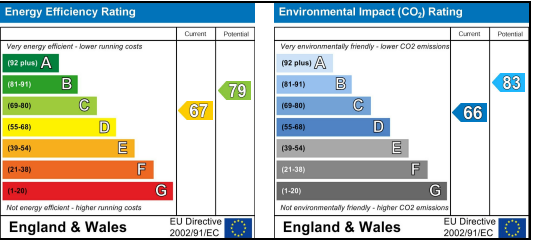

These particulars, whilst believed to be accurate are set out as a general outline only for guidance and do not constitute any part of an offer or contract. Intending purchasers should not rely on them as statements of representation of fact, but must satisfy themselves by inspection or otherwise as to their accuracy. No person in this firms employment has the authority to make or give any representation or warranty in respect of the property.