

# Castle Wildish



## Esher Road

, Hersham Village, Walton on Thames, KT12 4LP

A chance to acquire this spacious first floor apartment requiring some updating internally. The property forms part of The Leys development, with its stunning views over the River Mole & Garsons Farm. The property will be sold with the benefit of a brand new lease and share of freehold. The apartment also benefits from a south facing balcony with views over the River Mole, there is also a private garage in a nearby block with further residents and visitor parking.

To be sold with no onward chain!

**Offers Over £300,000**



# Esher Road

, Hersham Village, Walton on Thames, KT12 4LP



- First Floor Apartment Overlooking River Mole & Garsons Farm
- Delightful Communal Grounds Leading Down To The River Mole
- New 999 Year Lease & Share Of Feehold
- Requiring Updating Internally
- Residents Are Able To Fish And use Non-motorised Craft On The River
- Easy Access To Hersham Village Centre & Mainline Station
- Garage & Residents Parking
- Full Gas Central Heating
- No Onward Chain!

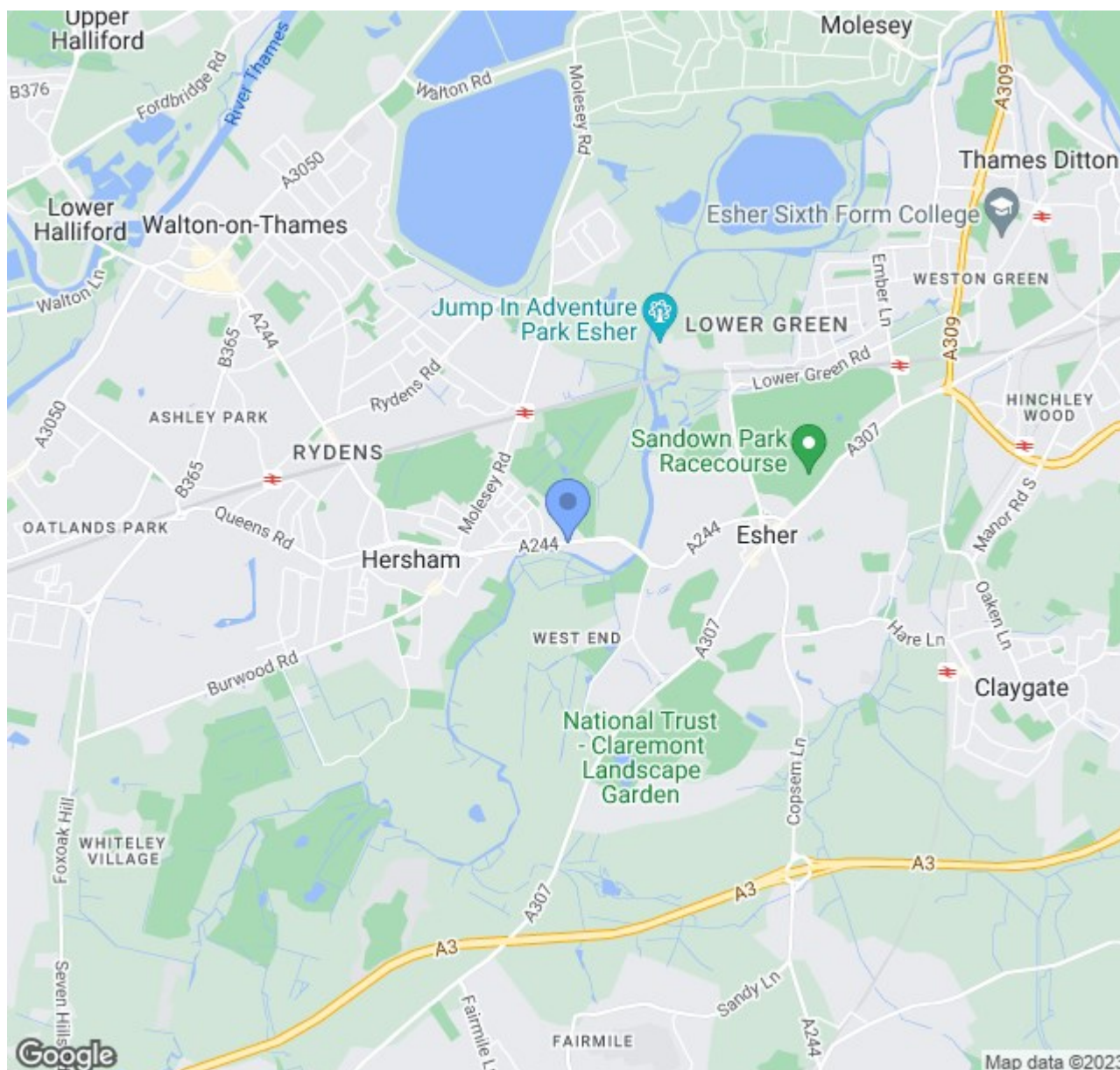





Esher Road, Hersham

Approximate gross internal floor area 765 sq/ft - 71 m/sq

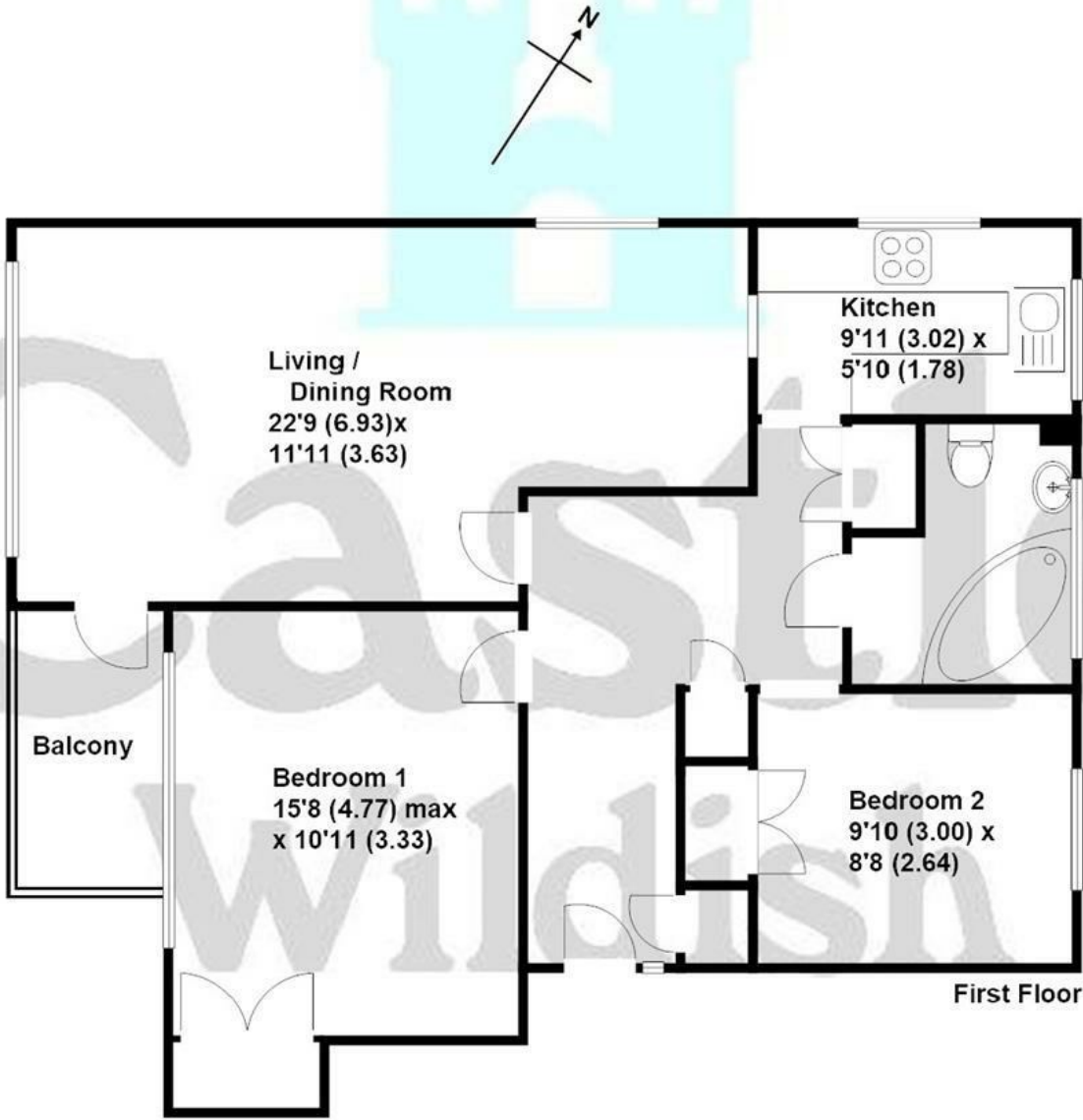

These plans are not drawn to scale and are for representational purposes only.  
The services, systems and appliances listed in these details have not been tested  
by Castle Wildish, and no guarantee is given to their operational ability or efficiency.  
Copyright Castle Wildish 2023  
Created by www.visionwithin.co.uk

These particulars, whilst believed to be accurate are set out as a general outline only for guidance and do not constitute any part of an offer or contract. Intending purchasers should not rely on them as statements of representation of fact, but must satisfy themselves by inspection or otherwise as to their accuracy. No person in this firms employment has the authority to make or give any representation or warranty in respect of the property.

