

Castle Wildish



Pleasant Place

, Hersham Village, KT12 4HR

A charming semi detached Victorian Cottage, situated in a convenient and quiet road close to Hersham Village Centre. The property offers much charm and character throughout, including a feature fireplace to the double aspect living room. Other noteworthy features would be the large kitchen breakfast room with direct access onto the lovely rear garden. There is a private driveway to the side of the house, with parking for up to two cars, or space for an extension, subject to the usual consents.

To be sold with no onward chain!

£475,000

Pleasant Place

, Hersham Village, KT12 4HR

 2

 1

 nul

 E



[Directions](#)



Pleasant Place, Hersham
Approximate gross internal floor area 734 sq/ft - 68 m/sq

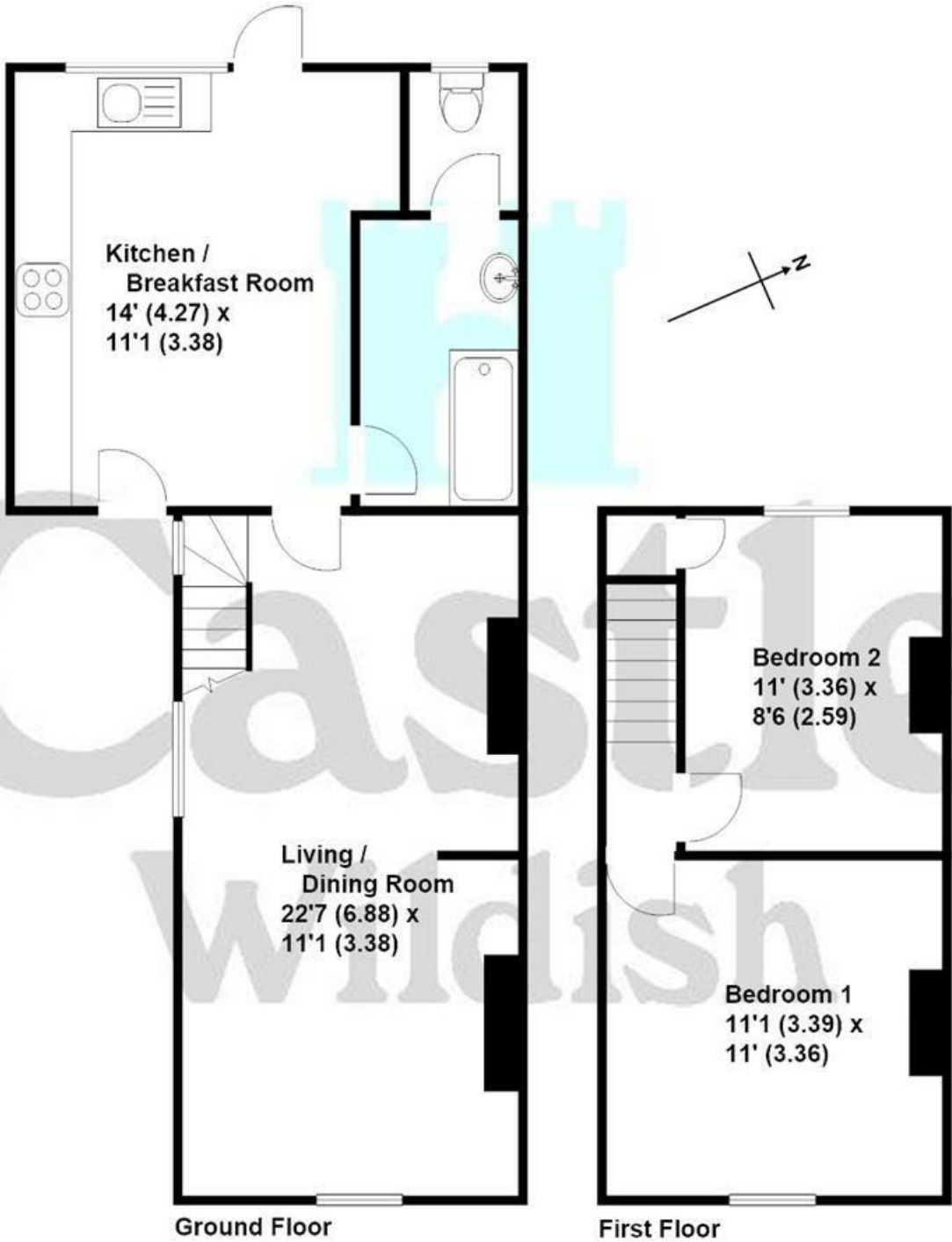

These plans are not drawn to scale and are for representational purposes only.
The services, systems and appliances listed in these details have not been tested by Castle Wildish, and no guarantee is given to their operational ability or efficiency.
Copyright Castle Wildish 2022.
Created by www.visionwithin.co.uk

These particulars, whilst believed to be accurate are set out as a general outline only for guidance and do not constitute any part of an offer or contract. Intending purchasers should not rely on them as statements of representation of fact, but must satisfy themselves by inspection or otherwise as to their accuracy. No person in this firms employment has the authority to make or give any representation or warranty in respect of the property.

