

Castle Wildish



Thrapps Lane , Hersham Village, KT12 4LY

A chance to purchase this much sought after two bedroom end of terrace house, located in a convenient position close to Hersham Village Centre. The property enjoys brights and spacious accommodation over two floors, with an additional south facing conservatory accessed from the rear of the living room.

Other features include a ground floor cloakroom and private garage to the rear with further visitor parking to the rear car park. The property also enjoys a south facing rear garden with pedestrian access form the rear and to the side of the house.

To be sold with no onward chain!

Offers Over £435,000

Thrupps Lane

, Hersham Village, KT12 4LY



- Two Good Size Bedrooms
- Useful Rear Conservatory
- Close To Village Centre
- Modern Fitted Kitchen
- Private Rear Garage & Parking
- Easy Access To Both Mainline Stations
- Ground Floor Cloakroom
- Full Gas Central Heating

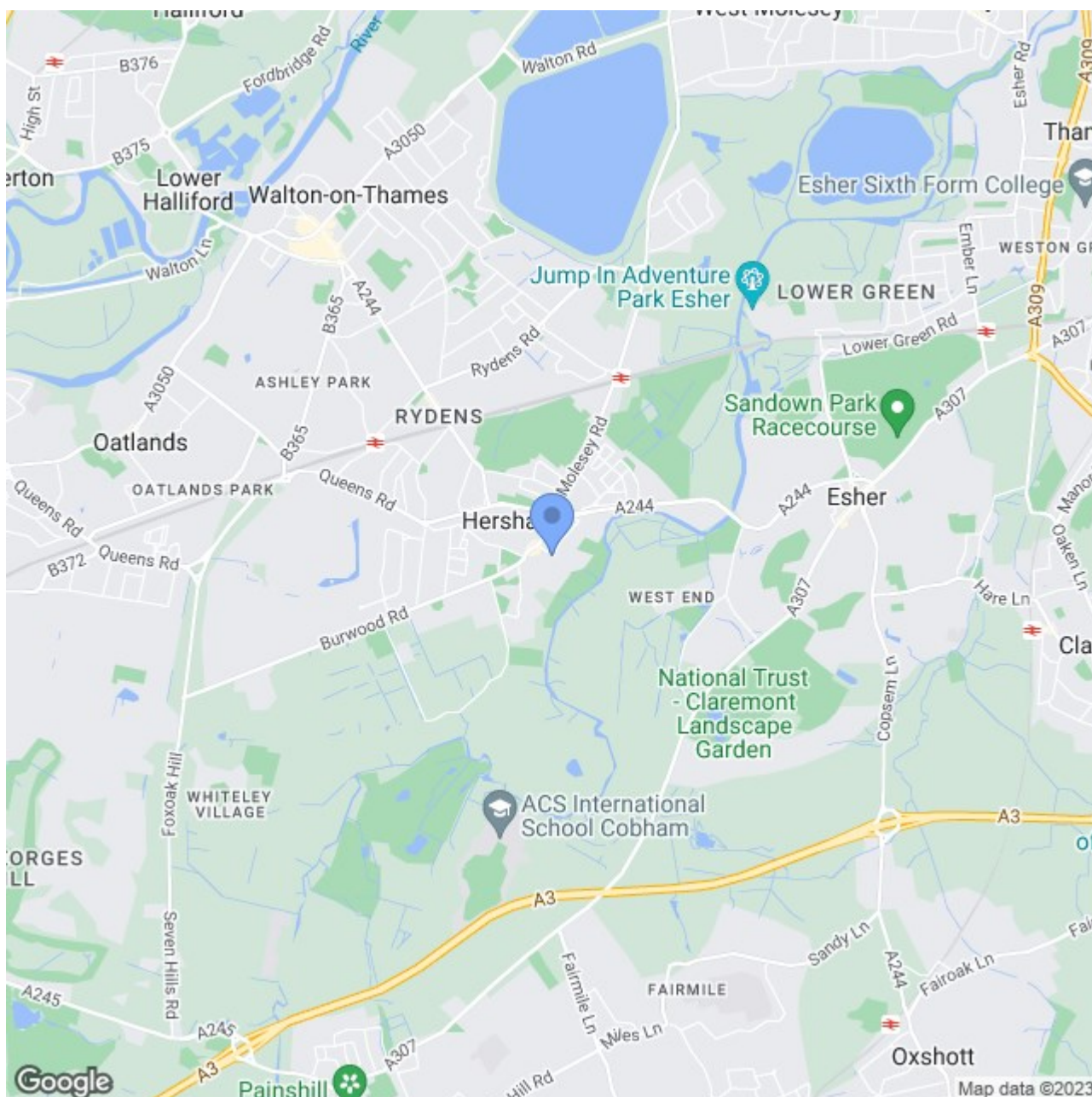



Thrupps Lane, Hersham

Approximate gross internal floor area 726 sq/ft - 67.5 m/sq

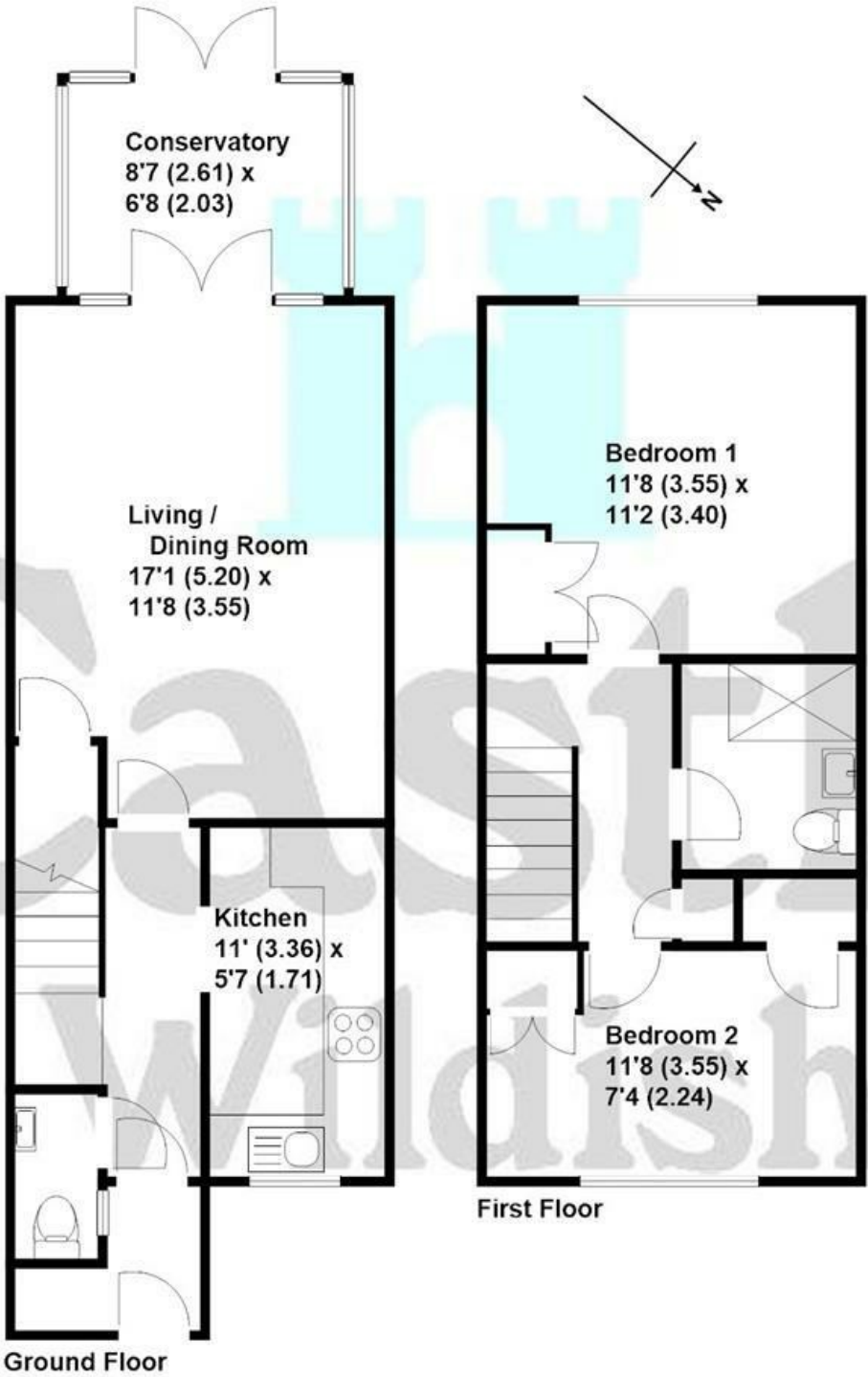

These plans are not drawn to scale and are for representational purposes only.
The services, systems and appliances listed in these details have not been tested
by Castle Wildish, and no guarantee is given to their operational ability or efficiency.
Copyright Castle Wildish 2023
Created by www.visionwithin.co.uk

These particulars, whilst believed to be accurate are set out as a general outline only for guidance and do not constitute any part of an offer or contract. Intending purchasers should not rely on them as statements of representation of fact, but must satisfy themselves by inspection or otherwise as to their accuracy. No person in this firms employment has the authority to make or give any representation or warranty in respect of the property.

