

Castle Wildish



Kenwood Drive

Burwood Park Environs, Hersham Village, KT12 5AX

Castle Wildish are pleased to offer a delightful and substantial Family Home, located in this much sought after road. The property offers good size accommodation over two floors and enjoys a lovely mature garden plot, with scope for extension [STPP].

Offers Over £1,300,000

Kenwood Drive

Burwood Park Environs, Hersham Village, KT12 5AX

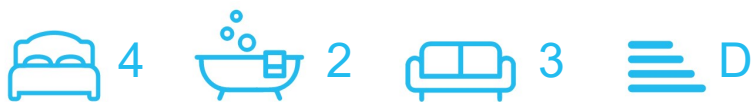

- Substantial Detached Four Bedroom Home
- Scope For Extension & Conversion
- Large Open Plan Living Room/Dining Room
- Secluded Mature Garden Plot
- Excellent Size Accommodation Over Two Floors
- Ground Floor Bedroom & Bathroom
- In-Out Driveway & Double Garage
- Easy Access To Walton on Thames Mainline Station

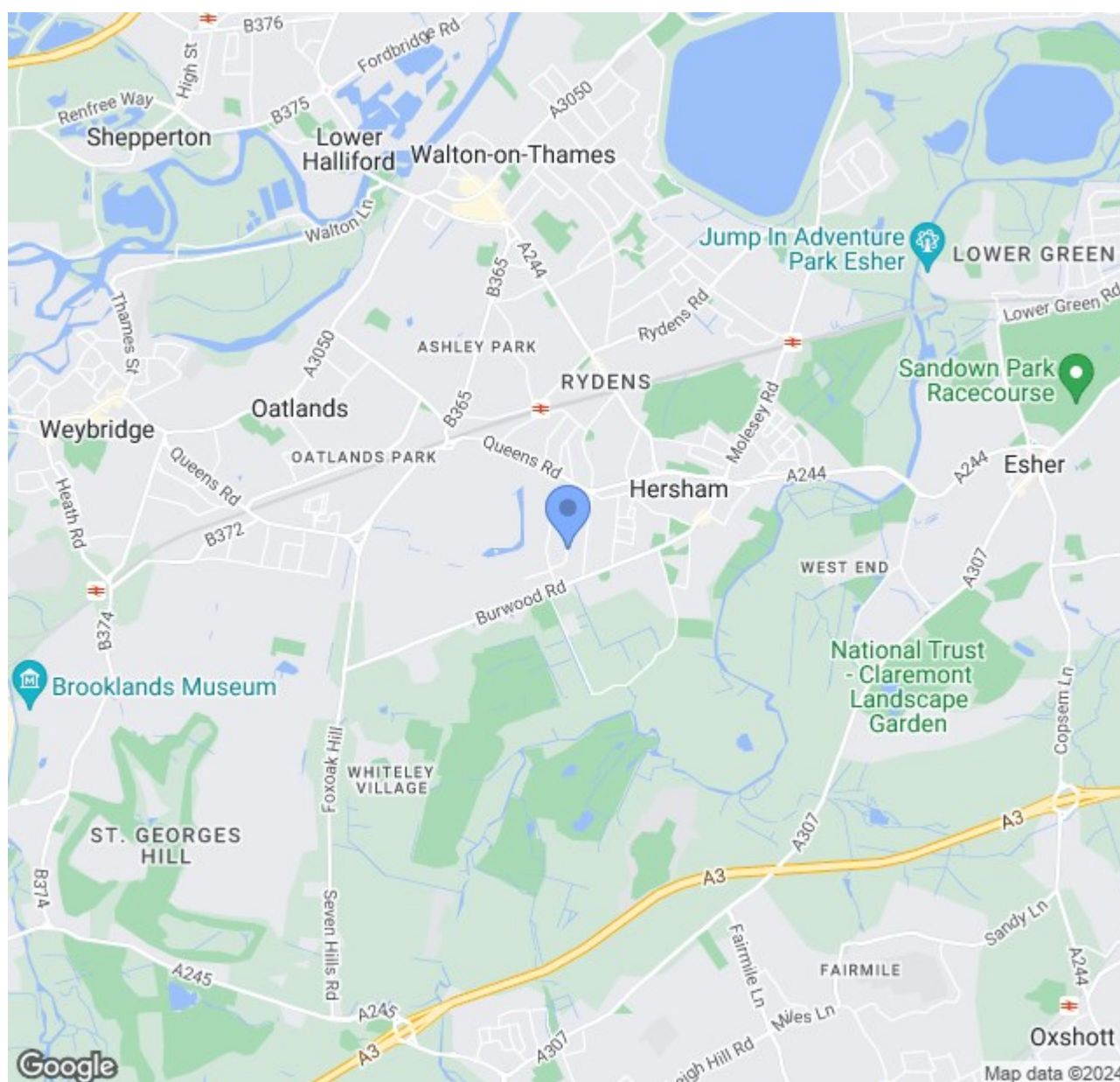



Kenwood Drive, Hersham
Approximate gross internal floor area 1818 sq/ft - 169 m/sq

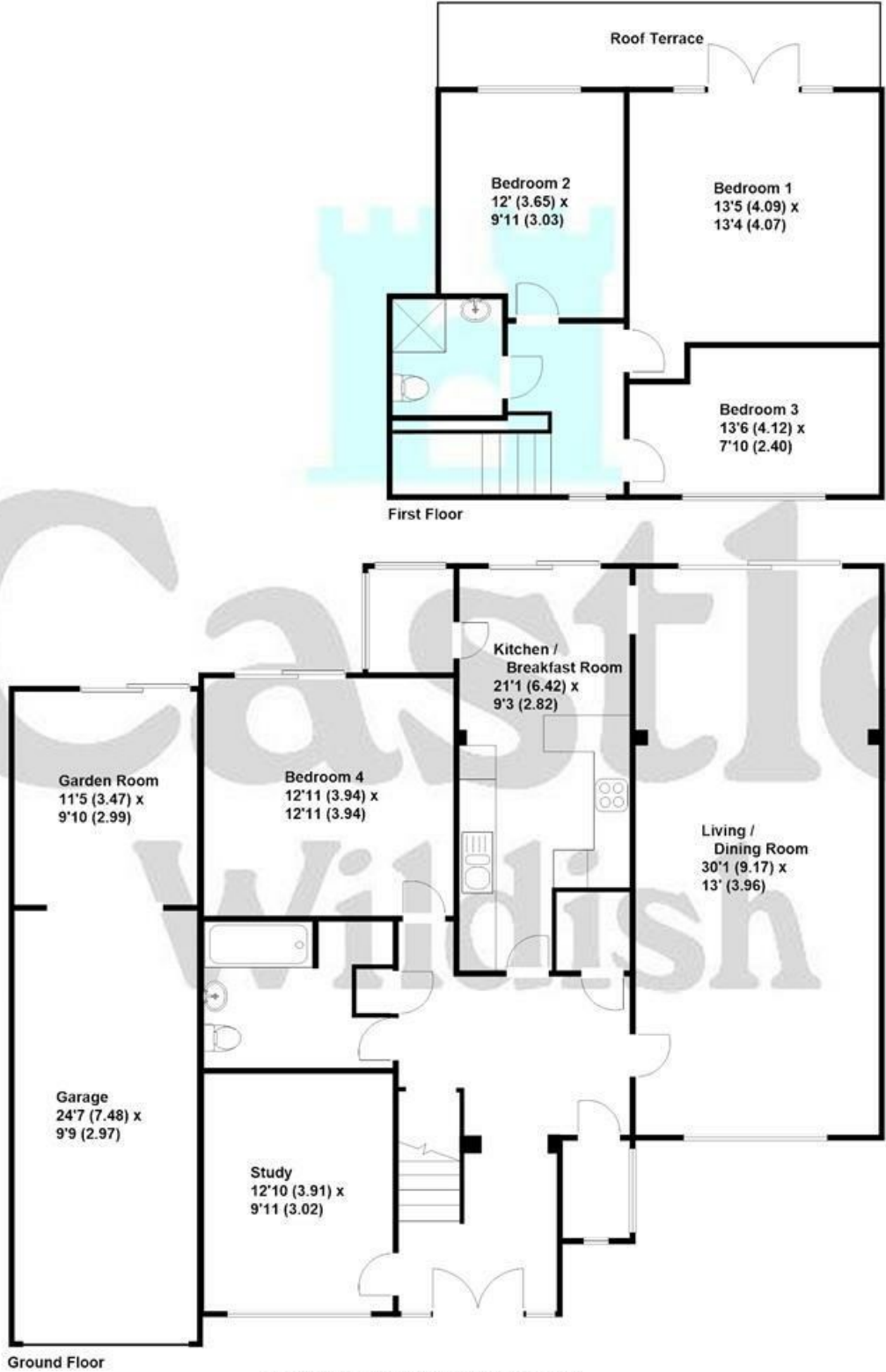

These plans are not drawn to scale and are for representational purposes only.
The services, systems and appliances listed in these details have not been tested
by Castle Wildish, and no guarantee is given to their operational ability or efficiency.
Copyright Castle Wildish 2024
Created by www.visionwreth.co.uk

These particulars, whilst believed to be accurate are set out as a general outline only for guidance and do not constitute any part of an offer or contract. Intending purchasers should not rely on them as statements of representation of fact, but must satisfy themselves by inspection or otherwise as to their accuracy. No person in this firms employment has the authority to make or give any representation or warranty in respect of the property.

