

Castle Wildish



25 Cowley Crescent
, Hersham Village, KT12 5RH

Viewing By Appointment Only

A chance to acquire this substantial four bedroom semi detached Family Home, being offered in excellent order throughout. The property has been beautifully maintained and updated by the present owners and offers many fine features, almost too numerous to mention, including a large garden with useful home office/outbuilding.

Located in a quiet residential road only ten minutes walk from Walton on Thames Mainline Station and a short walk to either Hersham Village Centre or Halfway shopping facilities.

Offers In Excess Of £800,000

25 Cowley Crescent

, Hersham Village, KT12 5RH

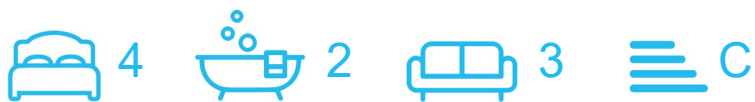

- Four Double Bedrooms, Two Bathrooms
- Large Fully Integrated And Equipped Kitchen
- Garden Aspect Family Room/Rear Reception With Double Doors
- Large Rear Garden With Useful Outbuildings
- Quiet Residential Road Within Easy Reach Of Mainline Station
- Master Bedroom With En Suite Bathroom
- Entrance Vestibule Leading To Entrance Hall
- Bright & Spacious Living Room
- Off Street Parking For Several Cars
- Separate Utility Room & Ground Floor Cloakroom

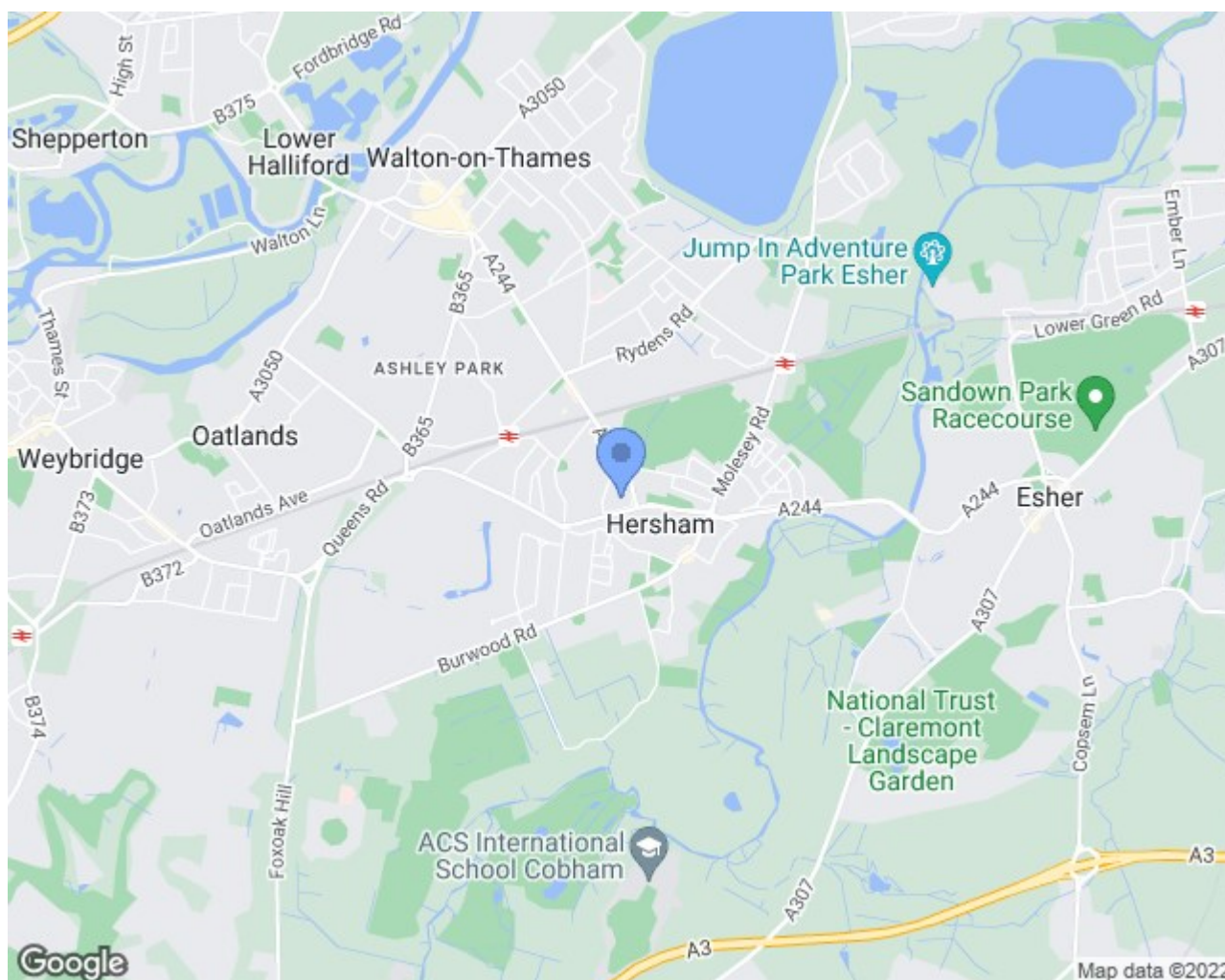



Cowley Crescent, Hersham
Approximate gross internal floor area 1647 sq/ft - 153 m/sq

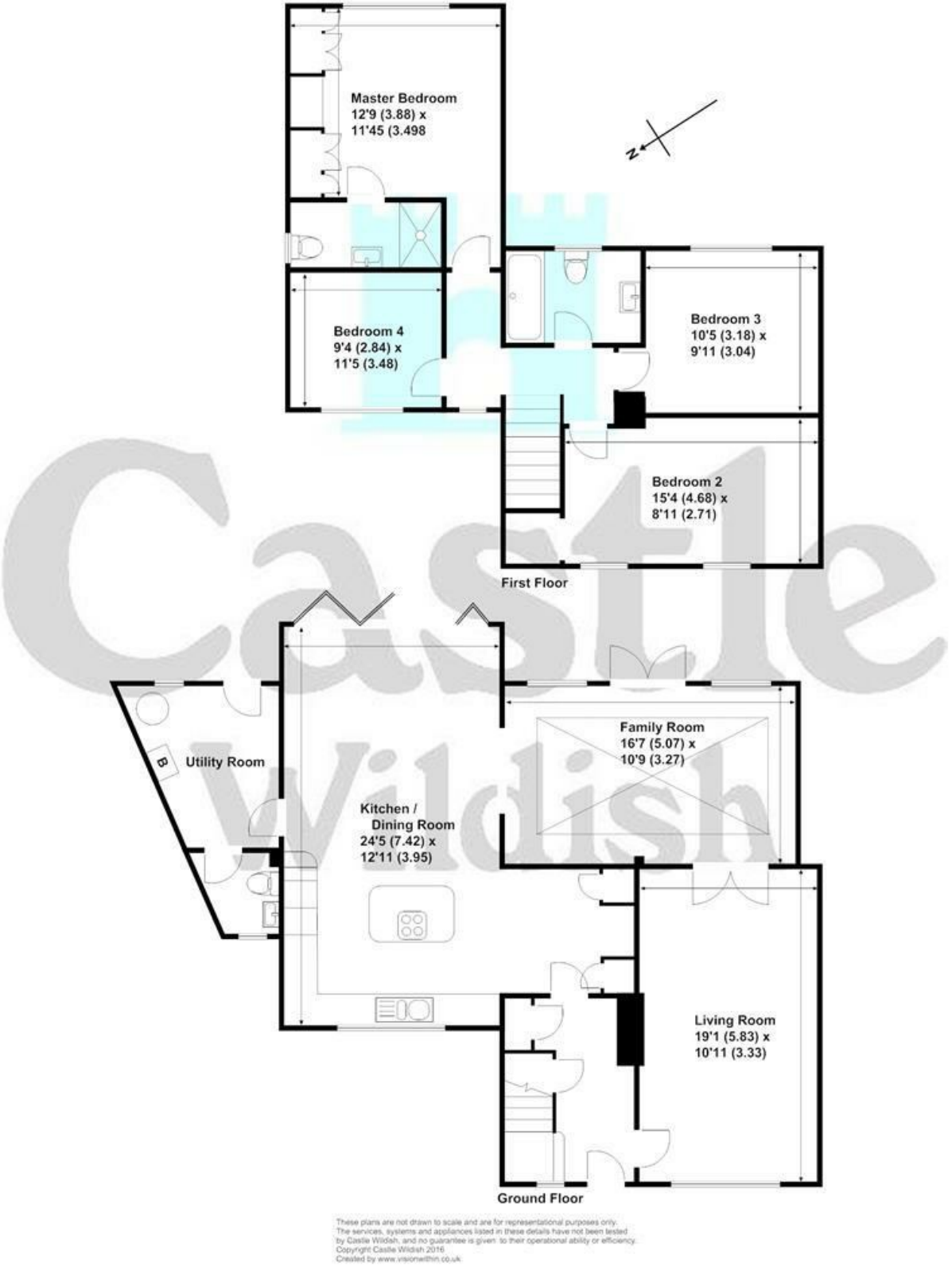

These particulars, whilst believed to be accurate are set out as a general outline only for guidance and do not constitute any part of an offer or contract. Intending purchasers should not rely on them as statements of representation of fact, but must satisfy themselves by inspection or otherwise as to their accuracy. No person in this firms employment has the authority to make or give any representation or warranty in respect of the property.

