

Castle Wildish



31 Mayfield Gardens , Hersham, KT12 5PP

Sold by Castle Wildish!

Castle Wildish offer this well planned four bedroom Family Home, located within very easy walking distance of Walton on Thames Mainline Station.

The property enjoys four good size bedrooms, master bedroom with en suite, plus a further Family bathroom. To the ground floor there are two separate reception rooms, along with a kitchen which is open plan to the dining/rear reception room, giving direct access onto the rear garden.

Other features include an integral garage and private driveway with parking for two cars, plus ground floor cloak room.

To be sold with no onward chain!

Guide Price £675,000

31 Mayfield Gardens

, Hersham, KT12 5PP



- Four Good Size Bedrooms
- Integral Garage & Driveway
- Open Plan Kitchen Dining Area
- Master Bedroom With En Suite
- Ideal For Commuters
- No Onward Chain!
- Quiet Residential Cul-de-sac Location

Full Description



Directions



Mayfield Gardens, Walton-on-Thames
Approximate gross internal floor area 1292 sq/ft - 120 m/sq

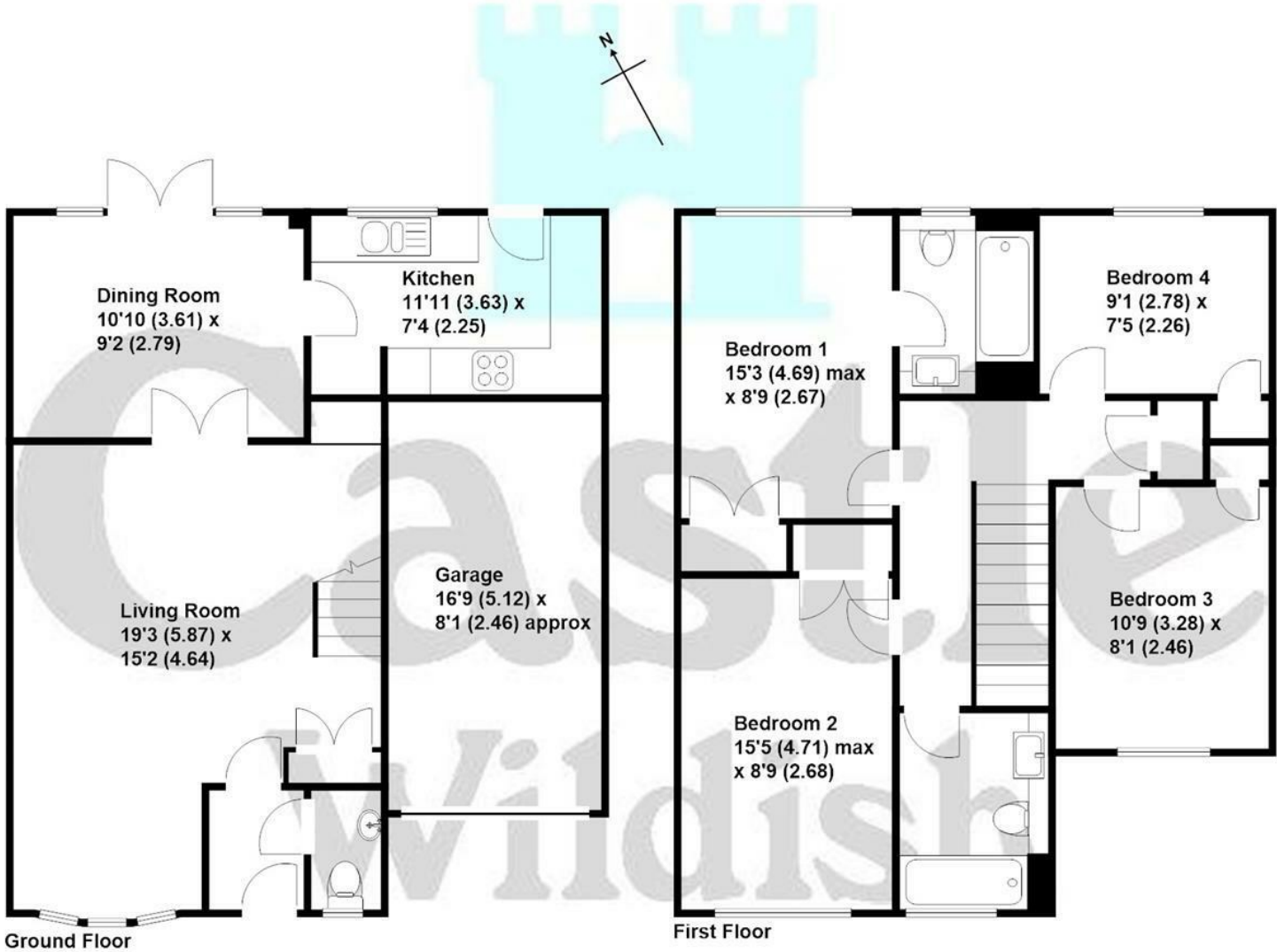

These plans are not drawn to scale and are for representational purposes only.
The services, systems and appliances listed in these details have not been tested
by Castle Wildish, and no guarantee is given to their operational ability or efficiency.
Copyright Castle Wildish 2019
Created by www.visionwithin.co.uk

These particulars, whilst believed to be accurate are set out as a general outline only for guidance and do not constitute any part of an offer or contract. Intending purchasers should not rely on them as statements of representation of fact, but must satisfy themselves by inspection or otherwise as to their accuracy. No person in this firms employment has the authority to make or give any representation or warranty in respect of the property.

