

Castle Wildish



Woodside Avenue , Hersham Village, KT12 5LG

Castle Wildish is proud to present this stunning Edwardian detached home on the market for the first time in nearly five decades. Situated on the highly desirable Woodside Avenue in Hersham, this property offers a rare opportunity to own a piece of history in a prime location.

Boasting six bedrooms spread over three floors, this spacious home is perfect for a growing family. The property features a generous 0.228 acre west-facing garden at the rear, providing a peaceful retreat from the hustle and bustle of daily life. With a detached garage and driveway at the front, parking is never an issue.

While the property does require some updating, it still retains many charming original features that add character and warmth to the home. There is also ample potential to extend and improve the property, subject to the necessary consents.

Conveniently located just a short walk from Walton-on-Thames Mainline Station, commuting is a breeze for residents. Nearby schools such as Burhill Primary and Cleves School make this an ideal location for families with children. For those who enjoy the outdoors, the property is surrounded by beautiful green spaces and parks.

Don't miss out on the chance to view this exceptional property. Contact Castle Wildish today to arrange a viewing and make this Edwardian gem your new home.

Offers Over £1,300,000

Woodside Avenue

, Hersham Village, KT12 5LG



- First Time To The Market In 47 Years
- Six Bedrooms & Three Separate Reception Rooms
- Detached Garage & Driveway
- Delightful Edwardian Family Home In Much Sought After Location
- Requiring Some Updating To the Kitchen & Bathrooms
- Short Walk Of Walton On Thames Mainline Station
- Many Lovely Original Features
- Beautiful Westerly Facing Rear Garden [0.228 acres in total]
- To Be Sold With No Onward Chain!

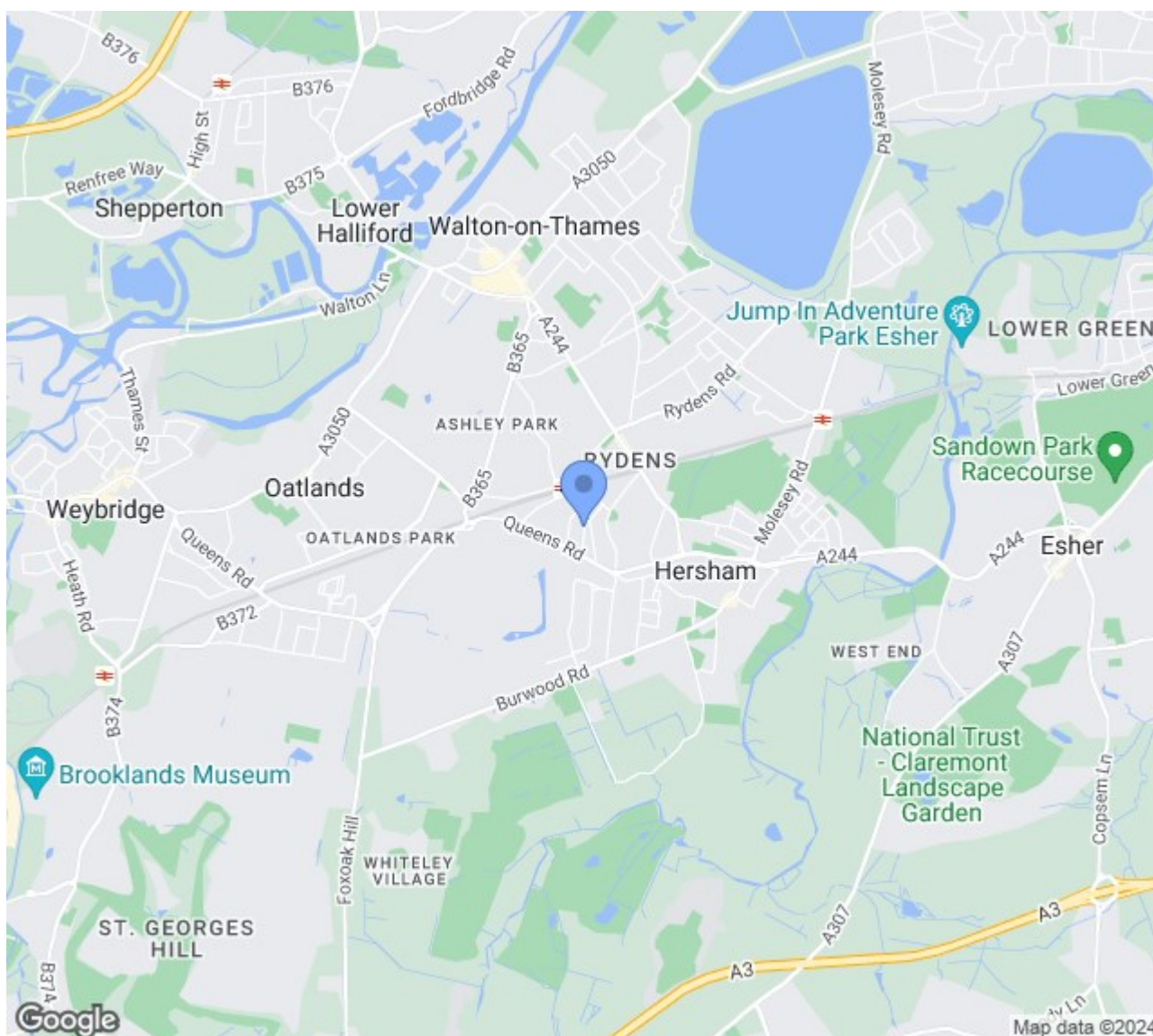



Woodside Avenue, Walton-on-Thames
Approximate gross internal floor area 2629 sq/ft - 244.3 m/sq

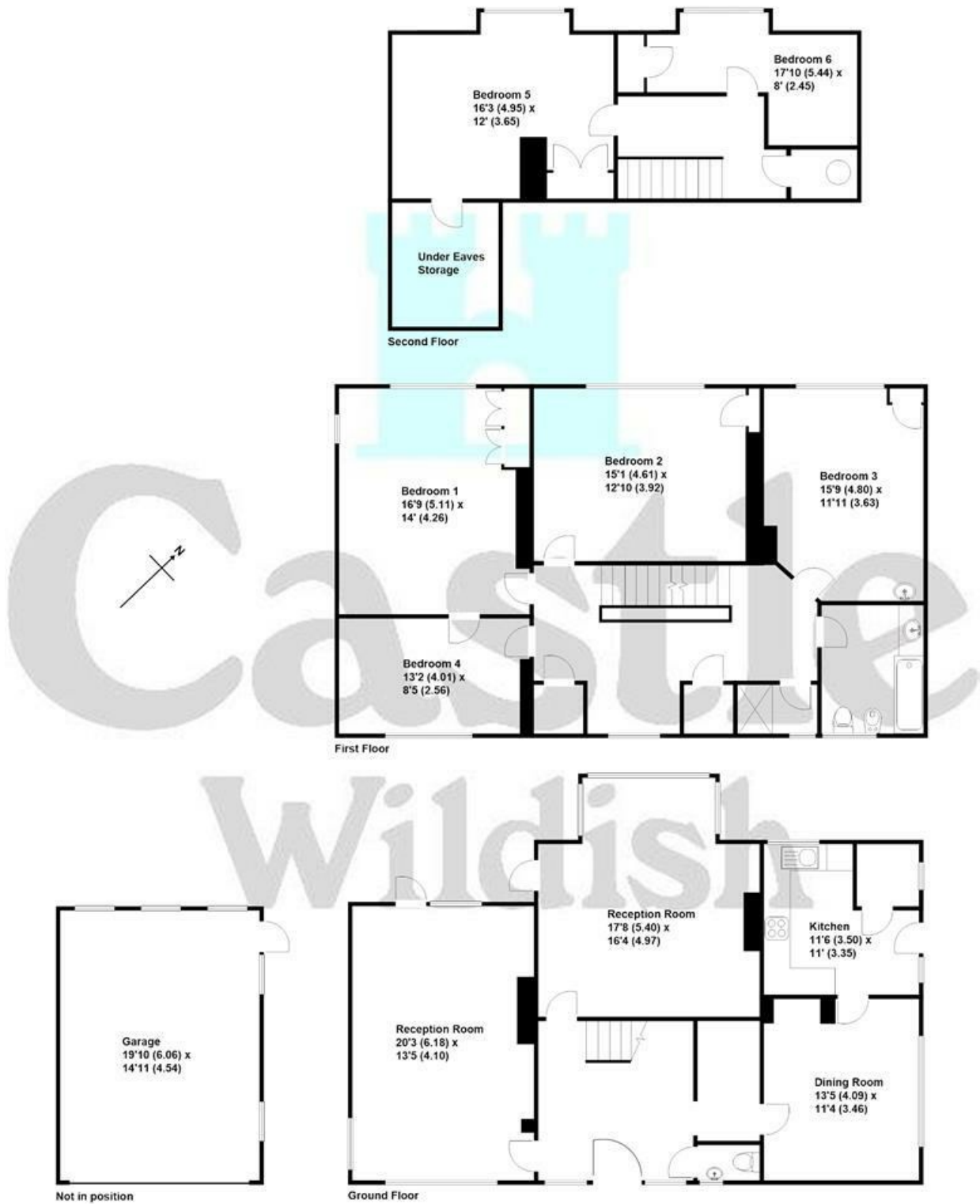

These plans are not drawn to scale and are for representational purposes only.
The services, systems and appliances listed in these details have not been tested
by Castle Wildish, and no guarantee is given to their operational ability or efficiency.
Copyright Castle Wildish 2024
Created by view streamer on uk

These particulars, whilst believed to be accurate are set out as a general outline only for guidance and do not constitute any part of an offer or contract. Intending purchasers should not rely on them as statements of representation of fact, but must satisfy themselves by inspection or otherwise as to their accuracy. No person in this firm's employment has the authority to make or give any representation or warranty in respect of the property.

