

Castle Wildish



Mole House, Kingfisher Close , Hersham Village, Walton on Thames, KT12 4LF

Castle Wildish are pleased to offer this stunning top floor apartment, with distant views over the River Mole & Garson Farm. The property has been completely refurbished throughout to a very high standard and enjoys an open plan living room leading to a private balcony. There are two double bedrooms, the master bedroom enjoying river views.

Forming part of the gated and much sought after Mole House development with its beautifully manicured lawns leading down to the River Mole. Located in a quiet part of the Village within easy walking distance to both Waitrose & Lidl stores, plus both Mainline Stations.

Appointments to view should not be missed.

Offers Over £350,000

Mole House, Kingfisher Close

, Hersham Village, Walton on Thames, KT12 4LF



- Delightful Top Floor Apartment With Stunning Views
- Long Lease & Share Of Freehold
- Newly Fitted Bathroom & Separate Cloakroom
- Easy Access To Both Mainline Stations
- Two Double Bedrooms, Master Bedroom With View Of River Mole
- Views Over River Mole & Garson Farm
- Low Outgoings & Residents Association
- Recently Refurbished Throughout
- Wooden Floors With Underfloor Heating
- Easy Walking Distance To Village Centre

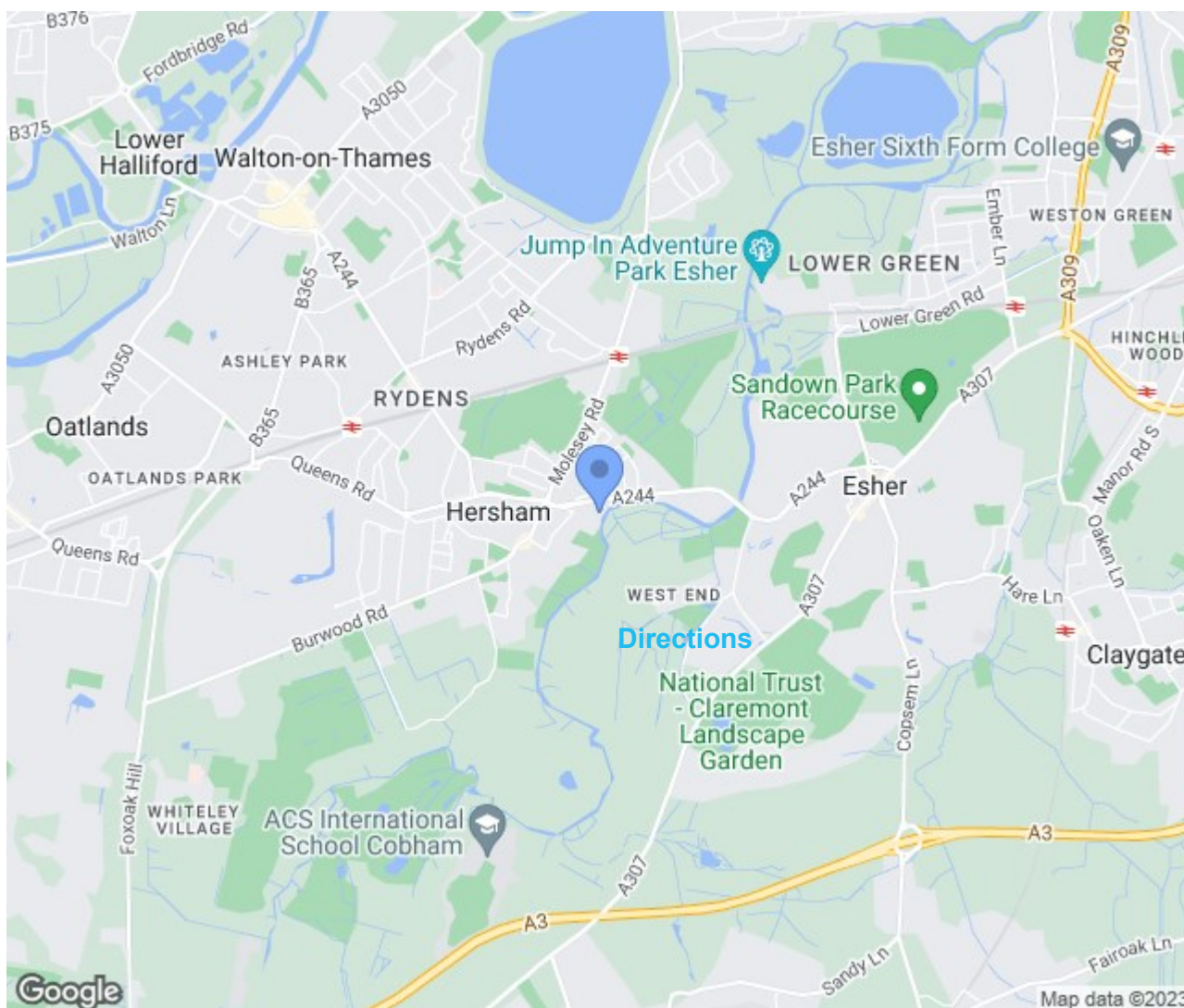



Kingfisher Close, Hersham

Approximate gross internal floor area 750 sq/ft - 69.7 m/sq

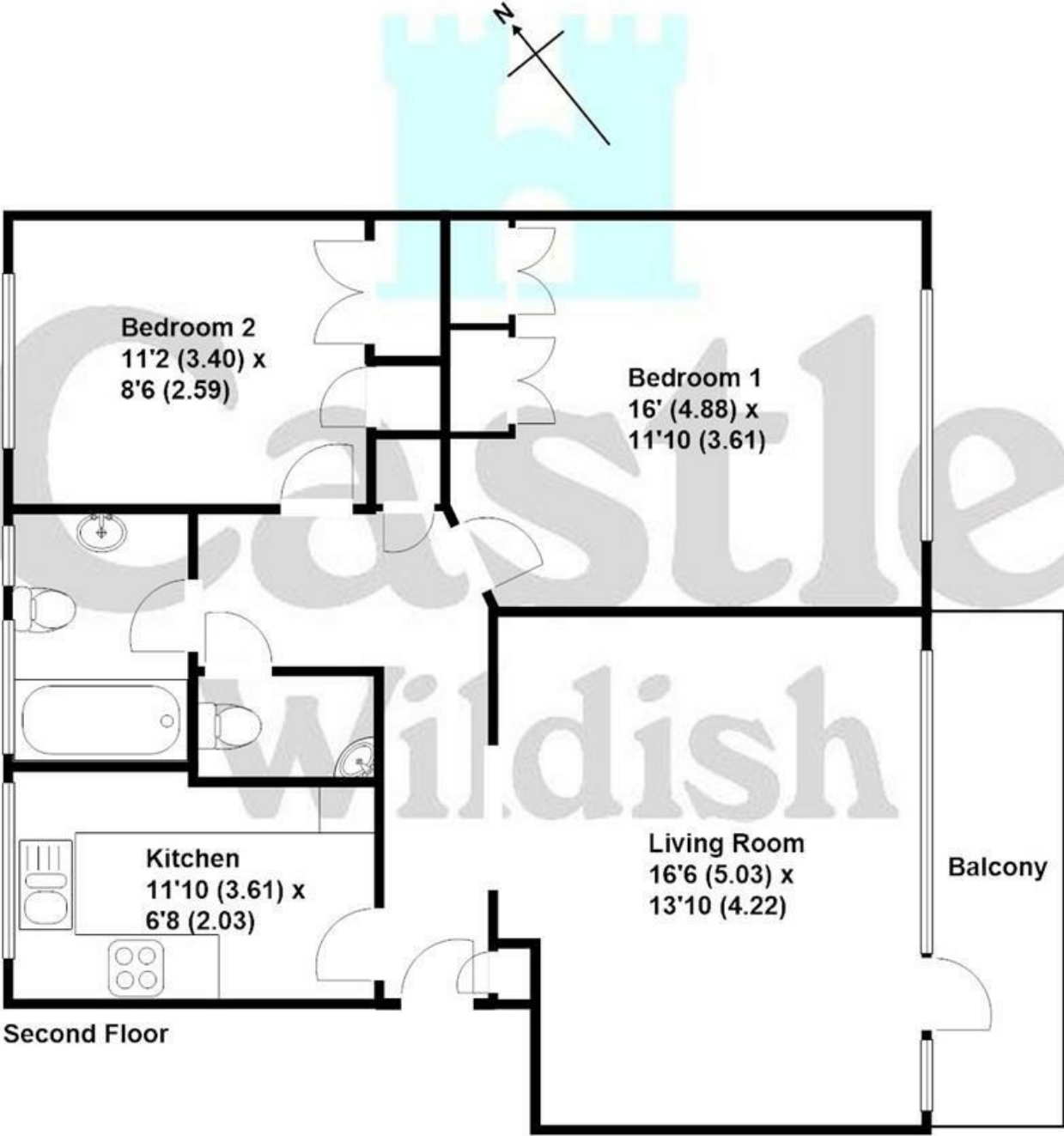

These plans are not drawn to scale and are for representational purposes only.
The services, systems and appliances listed in these details have not been tested
by Castle Wildish, and no guarantee is given to their operational ability or efficiency.
Copyright Castle Wildish 2022
Created by www.visionwithin.co.uk

These particulars, whilst believed to be accurate are set out as a general outline only for guidance and do not constitute any part of an offer or contract. Intending purchasers should not rely on them as statements of representation of fact, but must satisfy themselves by inspection or otherwise as to their accuracy. No person in this firms employment has the authority to make or give any representation or warranty in respect of the property.

