

Oxhey Avenue, Watford

£450,000

GROUND FLOOR
39.1 sq.m. (421 sq.ft.) approx.

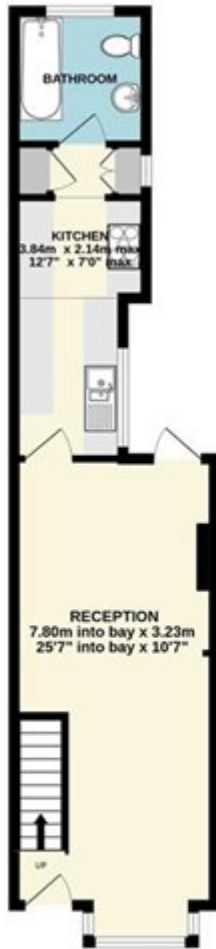

1ST FLOOR
28.1 sq.m. (302 sq.ft.) approx.



OXHEY AVENUE

TOTAL FLOOR AREA: 67.2 sq.m. (723 sq.ft.) approx.

Whilst every attempt has been made to ensure the accuracy of the floorplan contained herein, measurements of doors, windows, rooms and any other items are approximate and no responsibility is taken for any error, omission or mis-statement. This plan is for illustrative purposes only and should be used as such by any prospective purchaser. The services, systems and appliances shown have not been tested and no guarantee as to their operability or efficiency can be given.
Made with Metropix ©2024