

# Thrupps Lane, Hersham Village

Offers over £435,000

---

## Thrupps Lane, Hersham

Approximate gross internal floor area 726 sq/ft - 67.5 m/sq

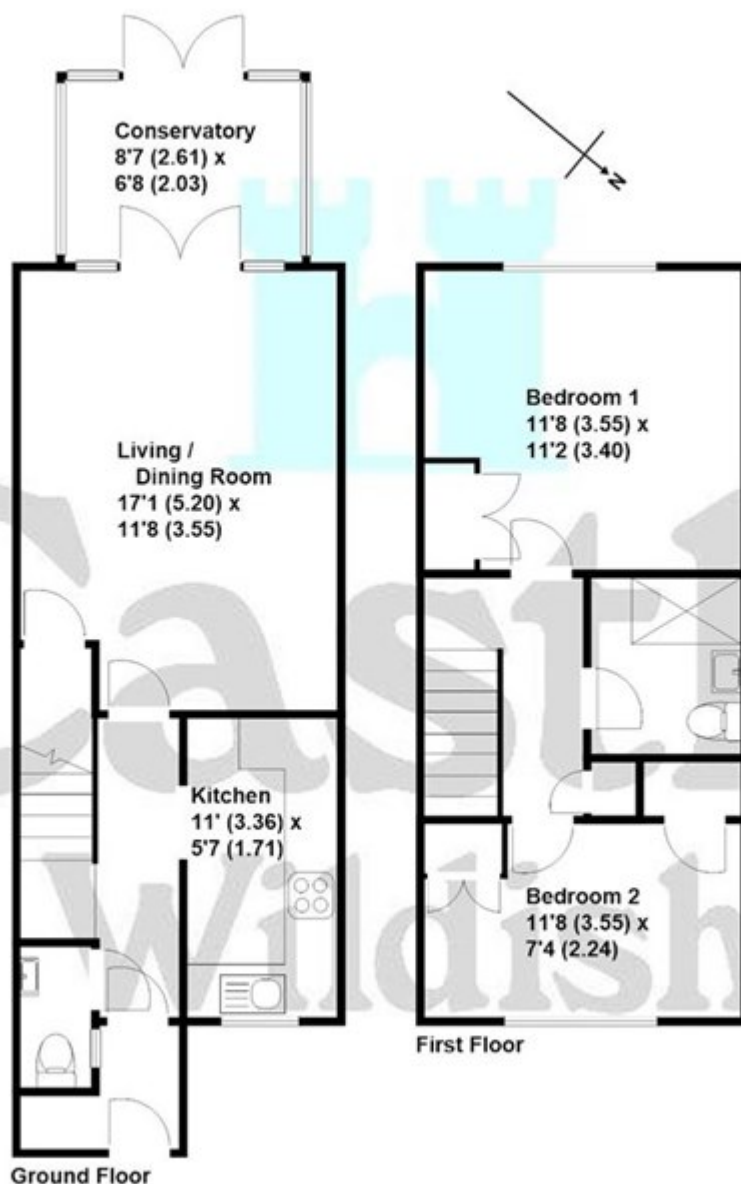

These plans are not drawn to scale and are for representational purposes only.  
The services, systems and appliances listed in these details have not been tested  
by Castle Wildish, and no guarantee is given to their operational ability or efficiency.  
Copyright Castle Wildish 2023  
Created by www.visionwriten.co.uk